



User Manual

Products:

AT3345BT

Powered Turntable System

DO NOT RETURN THIS PRODUCT TO THE STORE

If you have questions or need assistance, please call
customer service at (800) 243-0409

Contents

1. Important Safety Instructions.....	4
1.1 Safety	4
1.2 Caution.....	5
1.3 Warning.....	5
2. What's in the Box.....	6
3. Identifying the Parts	7
3.1 Turntable	7
3.2 Remote Control.....	8
3.3 Prepare the Remote Control Battery.....	8
3.4 Replace the Remote Control Battery	8
3.5 Precautions Concerning Batteries.....	8
4. Preparations	9
4.1 Attaching the platter	9
4.2 Attaching the dust cover.....	9
4.3 Setting Up the Turntable.....	10
4.4 Setting Tonearm Balance.....	10
4.5 Setting Tracking Force	10
4.6 Setting the Anti-Skate Adjustment	11
5. Connections	11
5.1 Use the AUX Socket.....	11
5.2 Use the LINE OUT Socket	11
5.3 Connect Power	11
6. Basic Operation	12
6.1 USB Operation.....	12
6.2 Bluetooth Operation.....	12
7. Playing a Vinyl Record	13
7.1 Before playing a Vinyl Record.....	13
7.2 Playing a Record.....	13
7.3 Pausing the Record	14
7.4 Stopping the Record	14
8. Replacing the Drive Belt	14
9. Standby	15
10. Care	15
10.1 Turntable Body	15
11. Troubleshooting.....	16
12. Specifications	17

1. Important Safety Instructions

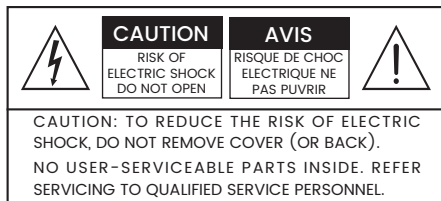



The lightning flash with arrowhead symbol, within an equilateral triangle, is intended to alert the user to the presence of uninsulated "dangerous voltage" within the product's enclosure that may be of sufficient magnitude as to constitute a risk of electric shock to persons.



The exclamation point within an equilateral triangle is intended to alert the user to the presence of important operating and maintenance (servicing) instructions in the literature accompanying the appliance.

1.1 Safety

- 1 **Read these instructions** – All the safety and operating instructions should be read before this product is operated.
- 2 **Keep these instructions** – The safety and operating instructions should be retained for future reference.
- 3 **Heed all warnings** – All warnings on the appliance and in the operating instructions should be adhered to.
- 4 **Follow all instructions** – All operating and usage instructions should be followed.
- 5 **Do not use this apparatus near water** – The appliance should not be used near water or moisture – for example, in a wet basement or near a swimming pool and the like.
- 6 **Clean only with a dry cloth.**
- 7 **Do not block any ventilation openings.** Install in accordance with the manufacturer's instructions.
- 8 Do not install near any heat sources such as radiators, heaters, stoves, or other apparatus (including amplifiers) that produce heat.
- 9 Do not defeat the safety purpose of the polarized or grounding plug. A polarized plug has two blades with one wider than the other. A grounding plug has two blades and a third grounding prong. The wide blade or the third prong is provided for your safety. If the provided plug does not fit into your outlet, consult an electrician for replacement of the obsolete outlet.
- 10 Protect the power cord from being walked on or pinched particularly at plugs, convenience receptacles, and the point where they exit from the apparatus.
- 11 Only use attachments/accessories specified by the manufacturer.
- 12  Use only with the cart, stand, tripod, bracket or table specified by the manufacturer, or sold with the apparatus. When a cart or rack is used, use caution when moving the cart/apparatus combination to avoid injury from tip-over.
- 13 Unplug the apparatus during lightning storms or when unused for long periods of time.
- 14 Refer all servicing to qualified personnel. Servicing is required when the apparatus has been damaged in any way, such as power supply cord or plug is damaged, liquid has been spilled or objects have fallen into the apparatus, the unit has been exposed to rain or moisture, does not operate normally, or has been dropped.
- 15  This equipment is a Class II or double insulated electrical appliance. It has been designed in such a way that it does not require a safety connection to electrical earth.
- 16 The apparatus shall not be exposed to dripping or splashing. No objects filled with liquids, such as vases, shall be placed on the apparatus.
- 17 Minimum distance around the apparatus for sufficient ventilation is 5cm.
- 18 The ventilation should not be impeded by covering the ventilation openings with items, such as newspapers, table-cloths, curtains, etc...
- 19 No naked flame sources, such as lighted candles, should be placed on the apparatus.
- 20 Batteries should be recycled or disposed of as per state and local guidelines.
- 21 The use of apparatus in moderate climates.

1.2 Caution

- Use of controls or adjustments or performance of procedures other than those described herein, may result in hazardous radiation exposure or other unsafe operation.
- To reduce the risk of fire or electric shock, do not expose this apparatus to rain or moisture. The apparatus must not be exposed to dripping or splashing and objects filled with liquids, such as vases, must not be placed on apparatus.
- The mains plug/appliance coupler is used as the disconnect device, the disconnect device must remain readily operable.
- Danger of explosion if battery is incorrectly replaced. Replace only with the same or equivalent type.

1.3 Warning

- The battery (batteries or battery pack) shall not be exposed to excessive heat such as sunshine, fire or the like.
- Before operating this system, check the voltage of this system to see if it is identical to the voltage of your local power supply.
- Do not place this unit close to strong magnetic fields.
- If any solid object or liquid falls into the system, unplug the system and have it checked by qualified personnel before operating it any further.
- Do not attempt to clean the unit with chemical solvents as this may damage the finish. Use a clean, dry or slightly damp cloth.
- When removing the power plug from the wall outlet, always pull directly on the plug, never yank on the cord.
- Changes or modifications to this unit not expressly approved by the party responsible for compliance will void the user's authority to operate the equipment.
- The rating label is pasted on the bottom or back of the equipment.

Battery usage CAUTION

To prevent battery leakage which may result in bodily injury, property damage, or damage to the apparatus:

- Install all batteries correctly, + and - as marked on the apparatus.
- Do not mix old and new batteries.
- Do not mix alkaline, standard (Carbon-Zinc) or rechargeable (Ni-Cd, Ni-MH, etc.) batteries.
- Remove batteries when the unit is not used for a long time.

WARNING:

- Replacement of a battery with an incorrect type may defeat a safeguard;
- Disposal of a battery into fire or a hot oven, or mechanically crushing or cutting of a battery, may result in an explosion;
- Leaving a battery in an extremely high temperature surrounding environment, such as sunshine, fire, or hot surface may result in an explosion or the leakage of flammable liquid or gas;
- A battery subjected to extremely low air pressure may result in an explosion or the leakage of flammable liquid or gas.

CAUTION: Risk of fire or explosion if the battery is replaced by an incorrect type!



Correct Disposal of this product. This marking indicates that this product should not be disposed with other household wastes throughout the EU. To prevent possible harm to the environment or human health from uncontrolled waste disposal, recycle it responsibly to promote the sustainable reuse of material resources. To return your used device, please use the return and collection systems or contact the retailer where the product was purchased. They can take this product for environmental safe recycling.



The Bluetooth® word mark and logos are registered trademarks owned by Bluetooth SIG, Inc. and any use of such marks by Zhong Shan City Richsound Electronic Industrial Ltd is under license. Other trademarks and trade names are those of their respective owners.

2. What's in the Box

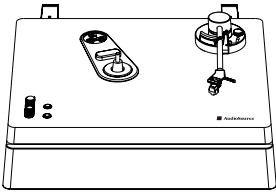

Turntable x 1

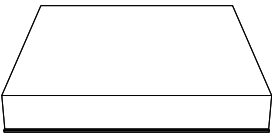

Dust Cover x 1



Counterweight x 1

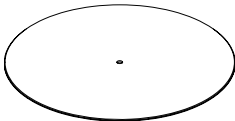

Rubber Mat x 1

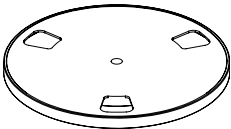

Platter x 1

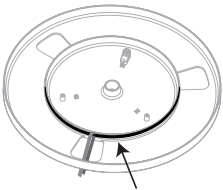

Drive Belt x 1



Remote Control x 1



AAA Batteries x 2



Power Cord x 1



Quick Start Guide /
User Manual



Warranty Card

- Power cord quantity and plug type vary by regions.
- Images, illustrations and drawings shown on this User Manual are for reference only, actual product may vary in appearance.



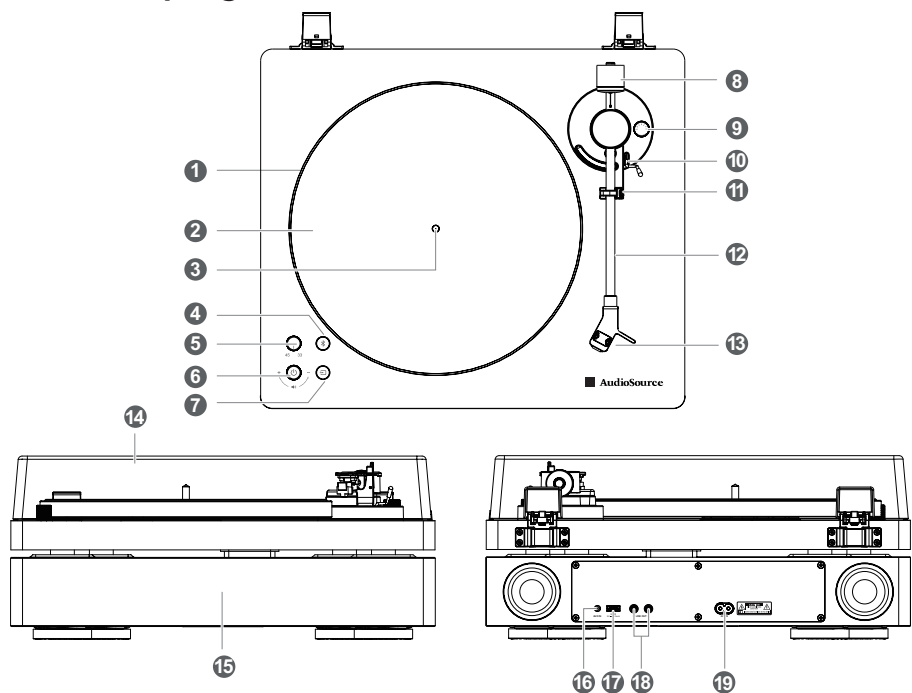

3. Identifying the Parts

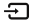

3.1 Turntable

- 1 **Platter**
- 2 **Rubber mat**
- 3 **Spindle**
- 4 **Bluetooth Button**
- 5 **Platter speed Knob**
Select the platter speed (33 or 45 RPM).
- 6 **⏻ (ON/OFF) button / Volume Knob**
Short press: ON/Standby
Clockwise rotation: Increases volume
Counterclockwise rotation: Decreases volume
- 7 **⏮ (SOURCE) button**
Select the play function.
- 8 **Counterweight**
Balances the tonearm and adjusts to provide the proper tracking force.
- 9 **Anti-skate Knob**
During vinyl playback, groove dynamics generate an inward pulling force on the stylus tip. This force is effectively counteracted by setting corresponding values for anti-skate and tracking force—for example, 2.0 g anti-skate with 3.5 g tracking force—to maintain optimal stylus alignment and minimize lateral bias.
- 10 **Tonearm lift control lever**
Operates the tonearm lift.
- 11 **Tonearm rest with clamp**
Use the clamp to secure the tonearm so that it does not move.
- 12 **Tonearm**
- 13 **Removable headshell**
- 14 **Dust cover**
- 15 **Display window**
Show the current status.
- 16 **AUX Socket**
- 17 **USB (Playback) Socket**
Insert the USB device to play music.
- 18 **Line Out (L/R) Socket**
Connect to an external amplifier or active speakers via the RCA cables for high-fidelity audio playback.
- 19 **AC~ Socket**
Use to connect the power cable.

3.2 Remote Control

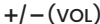
- | | | |
|----|---|---|
| 1 |  | Switch the unit between ON and STANDBY mode. |
| 2 |  | Select the play source. |
| 3 |  | Skip to previous/next track in Bluetooth/USB mode. |
| 4 |  | Play/pause/resume playback in Bluetooth/USB mode. |
| 5 |  | Select the Bluetooth mode.
Press and hold to activate the pairing function in Bluetooth mode or disconnect the existing paired Bluetooth device. |
| 6 | AUX | Select the AUX mode. |
| 7 | VINYL | Select the VINYL mode. |
| 8 |  | Mute or resume the sound. |
| 9 |  | Increase/decrease the volume level. |
| 10 | USB | Select the USB mode. |

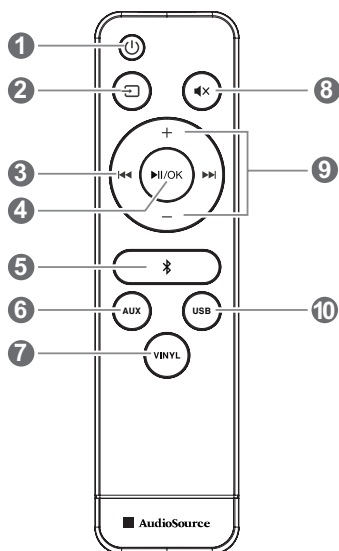

3.3 Prepare the Remote Control

The provided Remote Control allows the Sound Bar to be operated from a distance.

IMPORTANT: The remote control will work within a 6m range, however this may be impossible if there are obstacles between the Sound Bar and the control.

3.4 Replace the Remote Control Battery

1. Press and slide the back cover to open the battery compartment of the remote control.
2. Insert two AAA size batteries. Make sure the (+) and (-) ends of the batteries match the (+) and (-) ends indicated in the battery compartment.
3. Close the battery compartment cover.

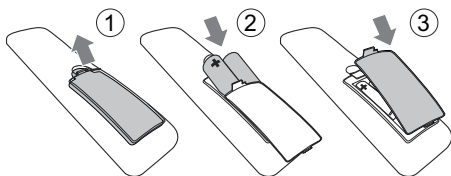

3.5 Precautions Concerning Batteries

- Be sure to insert the batteries with correct positive "⊕" and negative "⊖" polarities.
- Use batteries of the same type. Never use different types of batteries together.
- Either rechargeable or non-rechargeable batteries can be used. Refer to the precautions on their labels.
- Be aware of your fingernails when removing the battery cover and the battery.
- Do not drop the remote control.
- Do not allow anything to impact the remote control.
- Do not spill water or any liquid on the remote control.
- Do not place the remote control on a wet object.
- Do not place the remote control under direct sunlight or near sources of excessive heat.
- Remove the battery from the remote control when not in use for a long period of time, as corrosion or battery leakage may occur and result in physical injury, and/or property damage, and/or fire.
- Do not use any batteries other than those specified.
- Do not mix new batteries with old ones.
- Never recharge a battery unless it is confirmed to be a rechargeable type.

4. Preparations

This product requires some assembly before using it for the first time. Do not connect the AC adapter until assembly is complete.

4.1 Attaching the Platter

1. Set the platter on the spindle.
- Make certain that the platter is fully seated on the spindle.

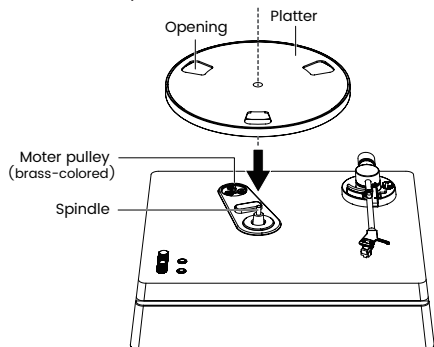

2. Place the belt on the motor pulley (brass-colored).
- Align the opening end of the platter with the paper strip toward the brass motor pulley, then hold the paper strip to mount the drive belt onto the motor pulley, as per the diagram. When doing this, be careful not to twist the drive belt.

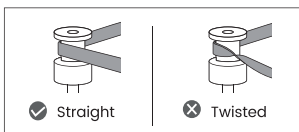
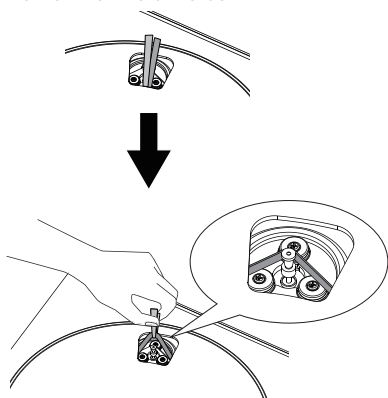

3. Remove the paper strip from the drive belt.

Note:

- Be careful to not let the drive belt twist. If the drive belt is twisted while placing it around the motor pulley, the speed will become unstable and the platter will stop after it begins rotating. If this happens, place the drive belt around the motor pulley again.
 - When placing the drive belt around the platter, do not stretch the drive belt roughly. Doing so degrades the drive belt, which causes the sound's pitch to fluctuate and be too high.
 - If the drive belt comes off of the platter's inner circle while you are placing the drive belt around it, temporarily remove the platter. Turn the platter over and wind the drive belt around the circumference of the inner circle. Then, start again from the beginning of the procedure.
4. Place the rubber mat for the platter onto the platter.
 5. Use your hand to slowly rotate the platter clockwise 10 times.

4.2 Attaching the Dust Cover

1. Align the dust cover's hinge slots with the mounting pins on the turntable base.

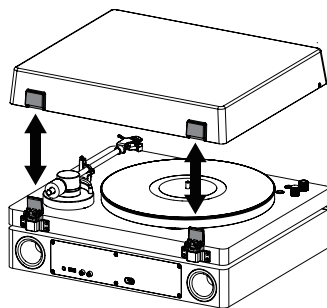

2. Lower the cover vertically until it fully seats into the hinges.
3. Verify secure attachment by gently lifting the cover—it should pivot smoothly without dislodging.

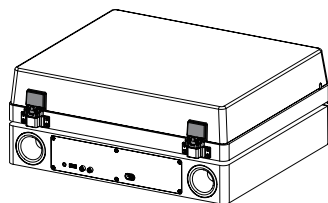

4.3 Setting Up the Turntable

Position the product on a stable level surface.

- To avoid the effects of vibrations and acoustic pressure, do not mount the product next to such items as speakers.

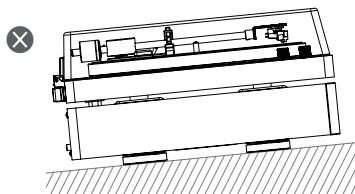
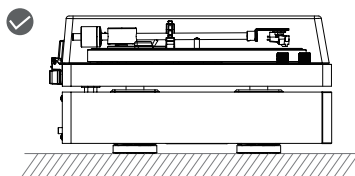

4.4 Setting Tonearm Balance

- Remove the cartridge's protector.

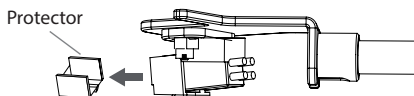

- While lightly holding the headshell to prevent the tonearm from moving, unlatch the clamp.

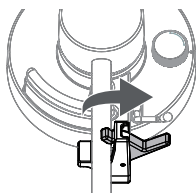

- The tonearm is tilted because the balance has yet to be adjusted.
- While gently holding the headshell, install the counterweight onto the tonearm shaft, then adjust the tonearm's balance by rotating the counterweight.
 - During installation of the counterweight, first press the dot button at the end of the tonearm while rotating the counterweight to the zero calibration mark.
 - Adjust the balance so that the tonearm is level when you release the headshell.

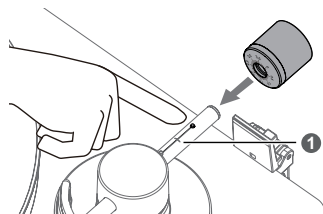

1 Zero Calibration Mark

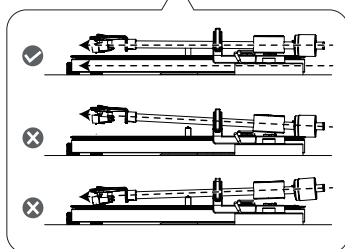
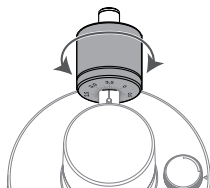

- Return the tonearm to the tonearm rest and latch the clamp.

4.5 Setting Tracking Force

- Firmly hold the counterweight to prevent movement, while simultaneously rotating the tracking force gauge ring until its "0" marking is precisely aligned with the centerline on the rear of the tonearm.
 - The tracking force is not adjusted simply by turning the tracking force gauge ring.

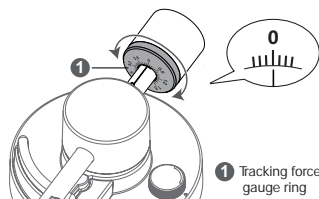

1 Tracking force gauge ring

- Turn the counterweight and the tracking force gauge ring together counterclockwise (to the left) until the centerline value matches the recommended tracking force value for the cartridge you are using.

- Refer to the cartridge maker's specifications for the recommended tracking force value.
- The standard tracking force value for the cartridge provided with this product is 3.5 g.

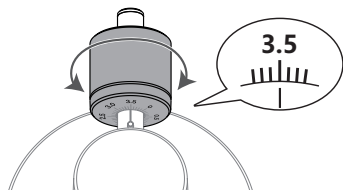

4.6 Setting the Anti-Skate Adjustment

1. Set the anti-skate control dial to 2.0 g.
- During vinyl playback, groove dynamics generate an inward pulling force on the stylus tip. To precisely counteract this force while using a tracking weight of 3.5 g, set the anti-skate control to 2.0 g. This 1.5 g differential compensation prevents excessive outward bias while maintaining optimal channel balance and minimizing stylus wear. Always verify settings using a test record's mono band to ensure the tonearm remains neutrally positioned during playback.

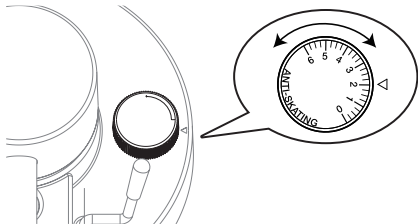

5. Connections

5.1 Use the AUX Socket

- A. Use a RCA to 3.5mm audio cable (not included) to connect the TV's audio output sockets to the AUX IN socket on the Turntable.
- B. Use a 3.5mm to 3.5mm audio cable (not included) to connect the TV's or external audio device headphone socket to the AUX IN socket on the Turntable.

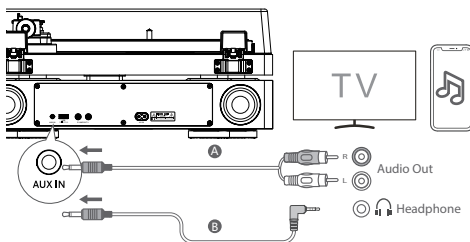

5.2 Use the LINE OUT Socket

- A. Use a RCA to 3.5mm audio cable (not included) to connect the an external amplifier or active speakers via to the LINE OUT (L/R) socket on the Turntable.
- B. Use a RCA audio cable (not included) to connect the an external amplifier or active speakers via to the LINE OUT (L/R) socket on the Turntable.

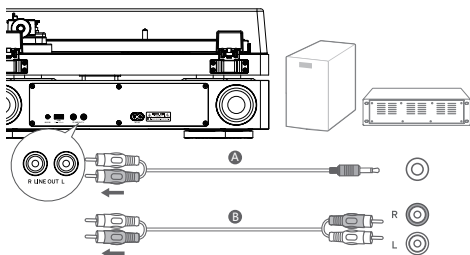

5.3 Connect Power

- **Risk of product damage!**
Ensure that the power supply voltage corresponds to the voltage printed on the back of the Turntable.
- Before connecting the AC power cord, ensure you have completed all other connections.
- Connect the mains cable to the AC~ Socket of the Turntable and then into a mains socket.

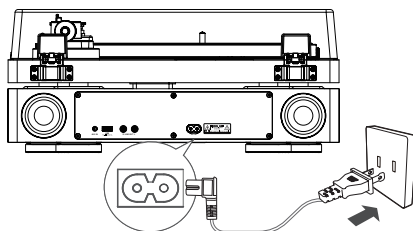



6. Basic Operation

6.1 USB Operation

By connecting a USB mass storage device (e.g. USB flash drive) to this Turntable, you can enjoy the device's stored music through the Turntable.

1. Insert the USB device.
2. Press the  (SOURCE) button repeatedly on the Turntable or press the USB button on the remote control to select the USB mode.

During playback:

 / OK Start, pause or resume play
 /  Skip to the previous or next track

Tips:

- The Turntable can support USB devices with up to 32 GB of memory.
- The player supports the USB music file format of MP3/WAV.
- This product may not be compatible with certain types of USB storage devices.
- If you use a USB extension cable, USB hub, or USB Multifunctional card reader, the USB storage device may not be recognized.
- Do not remove the USB storage device while reading files.

Note: Only USB storage devices formatted as FAT32 are supported.

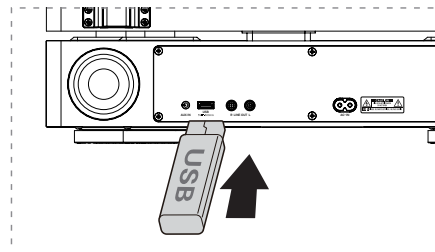

6.2 Bluetooth® Operation

Through Bluetooth, connect the Turntable with your Bluetooth device (such as an iPad, iPhone, iPod touch, Android phone, or laptop), and then you can listen to the audio files stored on the device through your Turntable.

First time pairing

1. Press the  Bluetooth button on the remote control or the Turntable. The display will scroll "NO BT".
2. Enable Bluetooth on your phone, search for and select **AT3345BT**.
3. Please wait while the Turntable pairs with your phone via Bluetooth. Once pairing is complete, you may begin playing music from your Bluetooth device.

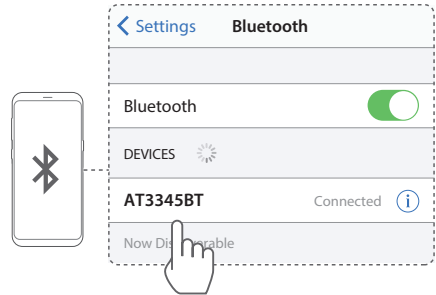

To pause / resume playback, Press the [Play / Pause] button on the remote control.

If you wish to connect this unit to another Bluetooth device, press and hold the  button on the Turntable or remote control. The LED screen will scroll "PAIRING", and the Turntable is in Bluetooth pairing mode again.

Tips:

If no other Bluetooth device connects within three minutes, the Turntable will reconnect to the previous Bluetooth device.

When the distance between the Bluetooth device and the Turntable exceeds the effective connection range, the Bluetooth connection will be disconnected. To reconnect, place the Bluetooth device within the effective connection range.

Some Bluetooth devices may not automatically reconnect after disconnection. Please reconnect manually if necessary.

If your phone is successfully connected to the Turntable and you receive a call or notification while playing music, the music will pause or reduce in volume to highlight the notification sound. The speaker will switch to your phone's speaker. If the music does not resume after the call ends, check the Bluetooth connection status / music app playback status, and volume settings on your phone.

7. Playing a Vinyl Record

7.1 Before Playing a Vinyl Record

1. Remove the cartridge's protector.
- If the tonearm is fixed to the tonearm rest, unlatch the clamp.

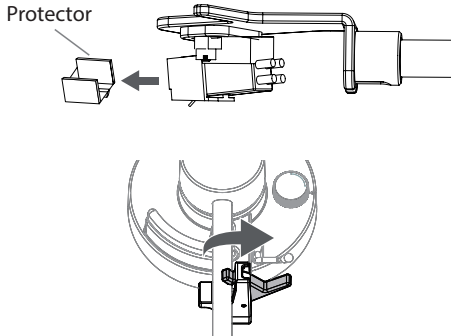

2. Place the record on the rubber mat so that the center hole aligns with the spindle.
- Rotate the Speed Selector Knob to set the desired playback speed: "33" for 33 RPM records, "45" for 45 RPM records.

Ensure the platter has fully stopped before switching speeds to prevent motor strain.

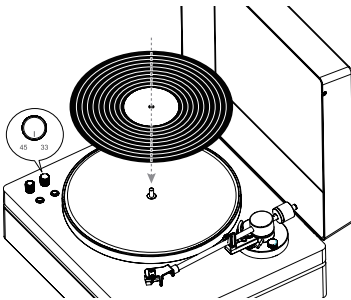

7.2 Playing a Record

1. Raise the tonearm by lifting the tonearm lift control lever to the UP position.

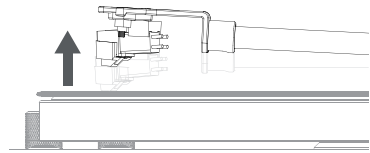
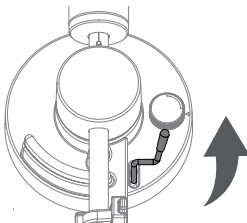

2. Position the tonearm over the desired location (groove) on the record.

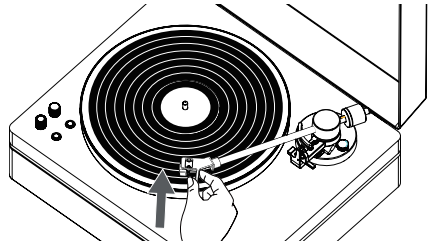

3. Slowly lower the tonearm by moving the tonearm to the DOWN position.

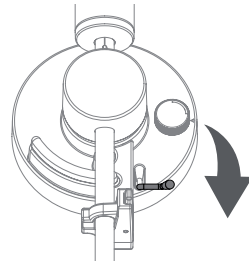

- Alternatively, you can skip steps 1 and 2, and use your fingers to lift the tonearm and move it over the desired location on the record, and then slowly place the tonearm down to begin playing the record.
- Lower the tonearm slowly so that it does not drop. Doing so could damage the stylus tip.
- Do not subject the product to strong impact during playback.
- Do not switch the record size selection while the record is playing. Doing so can cause the product to malfunction.
- 4. The tonearm descends slowly onto the record and play begins.

7.3 Pausing the Record

- **Lift the Tonearm lift control lever :** Raises the tonearm to pause playback.
- **Lower the Tonearm lift control lever :** Lower the tonearm to resume playback.

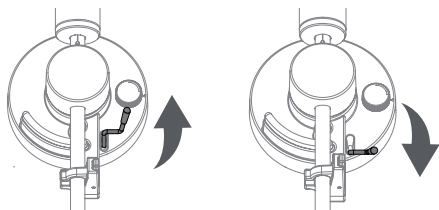

7.4 Stopping the record

1. Lift the tonearm lift control lever.
 2. Return the tonearm to the tonearm rest .
- The Turntable platter will automatically stop rotating.

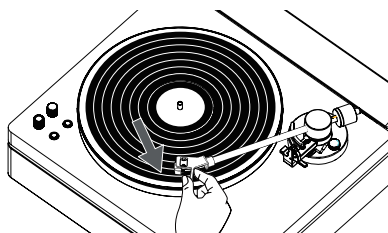

3. Remove the record after the platter has come to a complete stop.
- To prevent the record from becoming scratched or warped, remove it after use.
 - Do not use a platter other than the one provided.
 - The product is not intended for DJs. Do not touch the record or the platter while the record is playing.
4. Close the tonearm rest clamp.

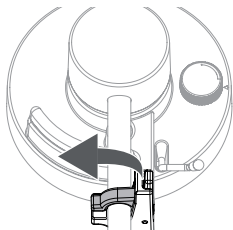

- Make sure the tonearm lift control lever is lowered before closing the tonearm rest clamp.
- Attach the protector.

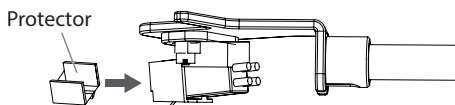

8. Replacing the Drive Belt

- The belt is a consumable part. Replace the belt if the speed of playback slows down or irregular rotation occurs. As a rule of thumb, we suggest replacing the belt once a year.
- Before replacing the belt, be sure to disconnect the product's AC power cord from the outlet.

1. Remove the rubber mat.

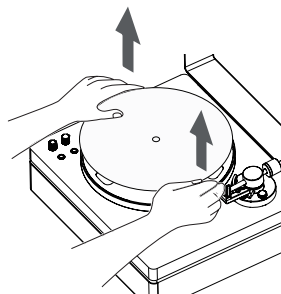

2. Remove the platter, turn the platter over, and then remove the old drive belt.
- Place your thumbs in the openings and pull up strongly.

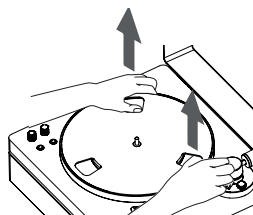

3. Place the new drive belt around the inner circle.
- Be careful not to twist the drive belt while doing this.

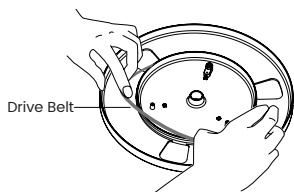

4. Attach the platter.
- Align one of the openings with the position of the motor pulley (brass-colored).

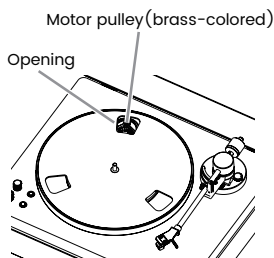

5. Place the drive belt on the motor pulley (brass- colored).
- Grasp the belt that was attached in step 3 and, while pulling it, place it on the brass motor pulley.

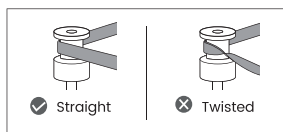
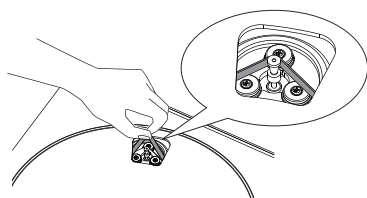

6. Set the rubber mat on the platter. Slowly rotate the Turntable ten times by hand in the direction of the arrow.

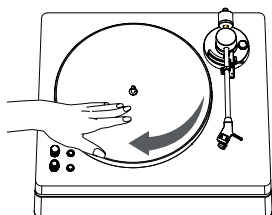

9. Standby

- When the Turntable has no input signal for over 15 minutes (in USB / AUX IN / Bluetooth / VINYL mode), it will automatically switch to Standby mode.
- To switch the Turntable off completely, remove the mains plug from the mains socket.
- Please turn the Turntable off completely to save energy when not in use.

10. Care

10.1 Turntable Body

- When the Turntable body is dirty or dusty, first disconnect the AC power cord, and then wipe off the dirt and dust with a soft, dry cloth.
- Do not use benzenes, thinners, etc.
- When storing the product for a long time, disconnect the AC power cord from the outlet and wrap the equipment in plastic; do not allow it to become damp.

11. Troubleshooting

To keep the warranty valid, never try to repair the system yourself. If you encounter problems when using this Sound Bar, check the following points before requesting service.

Problem	Solution
The platter does not spin	<ul style="list-style-type: none">• Is the AC power cord connected to the outlet? Connect AC power cord to the outlet.• Has the AC power cord's plug come off? Check whether or not the plug is properly attached to the AC power cord.• Check whether a belt is installed.
The platter spins, but there is no sound or the volume is not loud enough	<ul style="list-style-type: none">• Is the cartridge's protector still in place? Remove the cartridge's protector.• Is the tonearm in the lift position? Lower the tonearm.• Turn up the volume of the product.• Is the stylus damaged? Check the stylus and replace it, if necessary.• Is the stylus placed correctly on the body of the cartridge? Check the cartridge and adjust it, if necessary.• Is the tracking force set too heavy? Adjust the tracking force.
The stylus skips	<ul style="list-style-type: none">• Is the tracking force set too light or too heavy? Adjust the tracking force.• Is the anti-skate set improperly? Please verify that the anti-skate dial is set to 2.0 g.• Is the record warped? Check the record.• Is the record scratched? Check the record.
There is howling.	<ul style="list-style-type: none">• Is the product picking up excessive vibrations from the floor, surfaces of the walls, or nearby speakers?• Decrease the vibrations or mount the product on a surface that is not subject to the effects of vibrations.• Is the product mounted on an unstable surface? Check whether the surface on which the product is mounted is suitable.
There is noise when the record is playing.	<ul style="list-style-type: none">• Is there dust on the cartridge's stylus tip? If dust is stuck to the stylus tip, clean it with a commercially sold brush.
The sound when the record is playing is either too fast or too slow.	<ul style="list-style-type: none">• Are the speed settings for the product correct? Use the control knob to select the correct speed for the type of record being played.
No power	<ul style="list-style-type: none">• Ensure that the AC cord of the apparatus is properly connected .• Ensure that there is power at the AC outlet.• Press  (standby) button to turn the Turntable on.
I can't find the Bluetooth name of this Turntable on my Bluetooth device for Bluetooth pairing	<ul style="list-style-type: none">• Ensure the Bluetooth function is activated on your Bluetooth device.• The Turntable is already connected with another Bluetooth device. Disconnect the connected device. and then try again.• Place the product and the Bluetooth device within 1 m (3.3') of each other.

12. Specifications

Brand	AudioSource
Model	AT3345BT

Turntable

Motor	DC motor
Drive Method	Belt drive
Speeds	33 RPM, 45 RPM
Turntable Platter	Die-cast aluminum
Wow and Flutter	< 0.25% (WTD)
Signal-to-noise Ratio	≥ 45dB
Output Levels	LINE: 250±50 mV nominal at 1 kHz, 5 cm/sec

Tonearm Specifications

Effective Length	225 mm (8.86")
Overhang	18.5 mm (0.72")
Maximum Tracking Error Angle	Less than 2.0°

Cartridge Specifications

This product is equipped with an AT-3600L Dual Moving Magnet Stereo Cartridge. The cartridge cannot be removed.

Cartridge Model	AT-3600L
Cartridge Type	VM
Recommended Load Impedance	47,000 ohms
Output Voltage	2.5mV±3dB at1kHz (3.54cm/sec)
Stylus	0.6 mil bonded conical
Cantilever	Aluminum pipe

Bluetooth

Version	V5.4
Maximum Power Transmitted	< 10 dbm
Frequency Bands	2400 MHz ~ 2483.5 MHz

General Specifications

Power Supply	AC 100-240V~, 50/60Hz
Power Consumption Standby Power Consumption	< 0.5W
USB	5V  500mA
Dimensions (W × D × H)	17.19" x 7.2" x 14.56" inches
Net Weight	25.62 lbs

- Design and specifications are subject to change without notice.



FCC STATEMENT

1. This device complies with Part 15 of the FCC Rules. Operation is subject to the following two conditions:
 - (1) This device may not cause harmful interference, and
 - (2) This device must accept any interference received, including interference that may cause undesired operation.
2. Changes or modifications not expressly approved by the party responsible for compliance could void the user's authority to operate the equipment.

NOTE: This equipment has been tested and found to comply with the limits for a Class B digital device, pursuant to Part 15 of the FCC Rules. These limits are designed to provide reasonable protection against harmful interference in a residential installation.

This equipment generates uses and can radiate radio frequency energy and, if not installed and used in accordance with the instructions, may cause harmful interference to radio communications. However, there is no guarantee that interference will not occur in a particular installation. If this equipment does cause harmful interference to radio or television reception, which can be determined by turning the equipment off and on, the user is encouraged to try to correct the interference by one or more of the following measures:

- Reorient or relocate the receiving antenna.
- Increase the separation between the equipment and receiver.
- Connect the equipment into an outlet on a circuit different from that to which the receiver is connected.
- Consult the dealer or an experienced radio/TV technician for help.

Radiation Exposure Statement

This equipment complies with FCC radiation exposure limits set forth for an uncontrolled environment. This equipment should be installed and operated with minimum distance 20cm between the radiator & your body.

California Prop 65 Warning :



WARNING: This product can expose you to chemicals, including styrene, which is known to the State of California to cause cancer, and Bisphenol A, which is known to the State of California to cause birth defects or other reproductive harm. For more information, go to www.P65Warnings.ca.gov.

